

Courses and distances of the upper lot Beginning at M.O.C

- N 43 E 134 Post
- N 16 W 284 Chesnut
- N 75 E 49 M.O.C
- S 29 E 23 W.O.C
- S 3 1/2 E 65 Maple
- S 52 E 96 B.O. Follen
- S 55 W 44.4 W.O.C
- S 82 1/2 N 34 1/2 Stones
- N 70 W 8.8 Stones
- N 6 W 7.6 Stones
- N 85 W 40. Red O.C
- S 21 E 20 Stones
- S 65 1/2 W 13 Stones
- N 82 1/2 W 116 1/2 W.O.C the place of Beginning

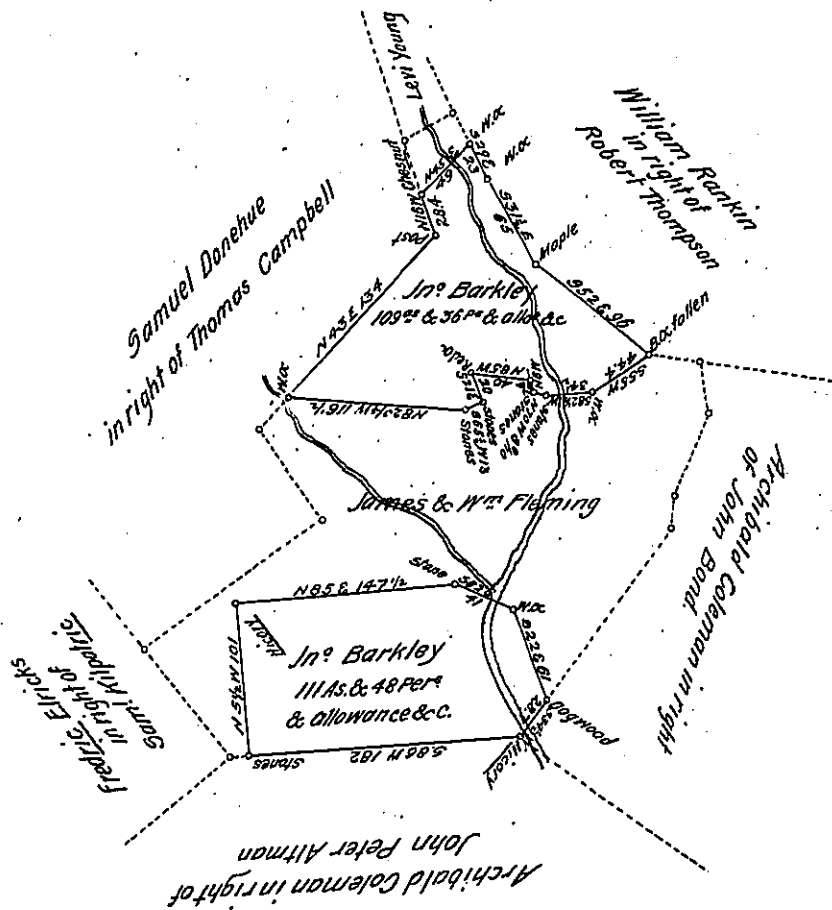

Resurveyed Nov. 10<sup>th</sup> 1855 to John Barkley the above described two pieces or parcels of land situate in Conemaugh Township Indiana County the two pieces containing two hundred and twenty Acres and Eighty four perches, and Allowance of six per Cent. for Roads &c being parts of a larger tract of land surveyed to John Hechlin on the 18<sup>th</sup> day of March A.D. 1789 in pursuance of a Warrant dated 6<sup>th</sup> day of September A.D. 1785 bounded as above described

J. Porter Donawley Esq. }  
Surveyor General

Thompson H.C. Cree  
County Surveyor

IN TESTIMONY that the above is a copy of the original remaining on file in the Department of Internal Affairs of Pennsylvania, made conformably to an Act of Assembly approved the 16th day of February, 1833, I have hereunto set my Hand and caused the Seal of said Department to be affixed at Harrisburg, this

eight<sup>th</sup> day of June 1906.

Loach  
Secretary of Internal Affairs.